

Medicina ENFit® Enteral Syringe Feeding System



The ENFit Enteral Syringe Range

Medicina has put together the largest range of accessories to help with the delivery of enteral feeds and medicines using the ENFit syringe feeding system. In the Medicina ENFit range, there are two types of enteral feeding syringes, the LPE Single Use and LHE Reusable ranges.



LPE ENFit Range - Single Use Syringes

The ENFit ISO Standard Single Use range of enteral syringes has been developed to deliver enteral feeds, medicines and flushes to neonatal, paediatric and adult patients throughout the hospital.

Features

- ISO 80369-3 Compliant (ENFit compatible)
- Purple
- Single use sterile
- Individually packaged
- Clear measurement markings
- Three piece syringe (barrel, plunger and silicone gasket)
- Latex/DEHP Free

LHE ENFit Range - Reusable Syringes

The ENFit ISO Reusable range of enteral syringes has been developed to deliver enteral feeds, medicines and flushes to neonatal, paediatric and adult patients at home.

Features

- ISO 80369-3 Compliant (ENFit compatible)
- Purple
- Reusable
- Individually packaged
- Clear measurement markings
- Three piece syringe (barrel, plunger and silicone gasket)
- Latex/DEHP Free
- O-ring on silicone gasket to prevent swelling when cleaning

Medicina ENFit Connection System

Only Tighten the ENFit Syringe and Nasogastric Tube Connections by 1/4 Turn



The ENFit System

- The ENFit syringe does not allow connectivity with non-ENFit connectors
- The ENFit syringe provides a secure locking feature that allows the connection to stay in place
- It is important that ENFit syringes are only filled with liquid up to, but not including, the connection port as this can clog the connector and lead to loss of fluid. The connector port should be left full of air (this refers to 5-60 mL syringes only)

The ENFit Locking Feature

Very important information for hospital and home users:

- When making connections to ENFit, **it is only necessary to tighten the connection by one quarter turn**
- This provides a good seal and will allow simple disconnection
- This includes replacing the caps on the nasogastric tubes

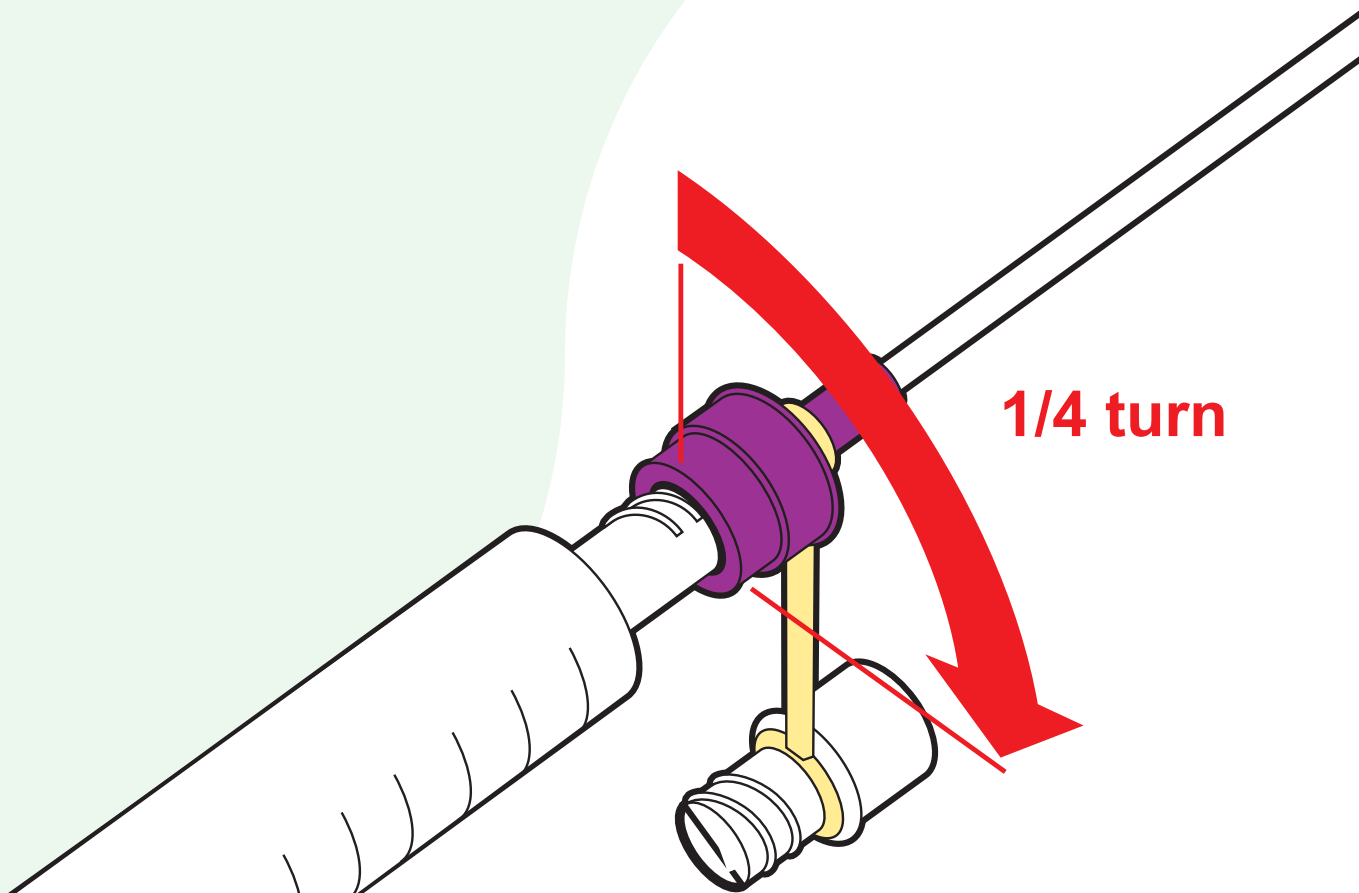
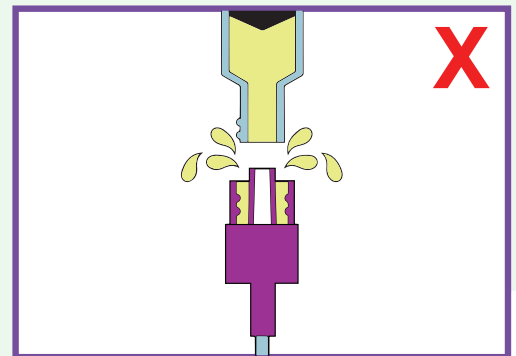
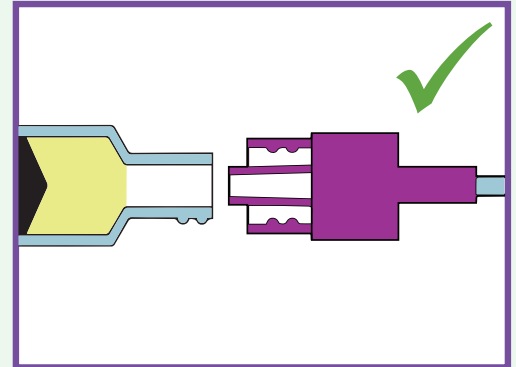

Making Connections

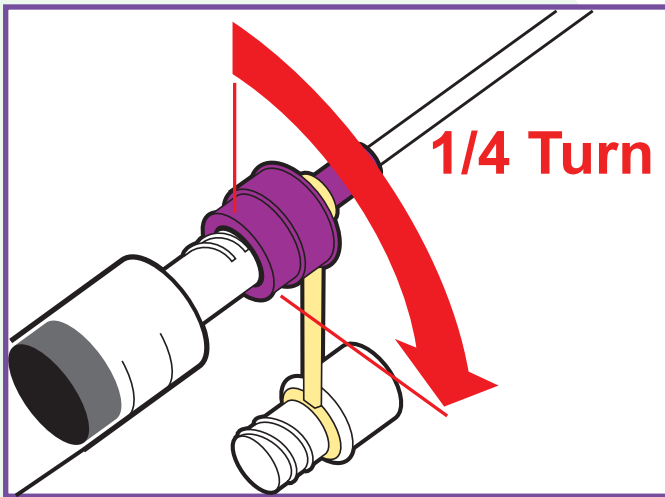

If you over-tighten the connection by more than 1/4 turn, you will find it very difficult to undo. This difficulty increases with the presence of feed or liquid medications left in the seal that can become very sticky and make disconnection increasingly strenuous. To prevent this from occurring, remember to only tighten the ENFit connection by 1/4 turn and to flush the seal of the Nasogastric tube with water from a syringe if milk, feed or liquid medications are left in the seal. This will ensure ease of use and uncomplicated connection and disconnection of the ENFit system.

Note: Please avoid the use of external tools to undo the connection as they may cause the cap to break or the tether to split.

Flushing Connector Threads

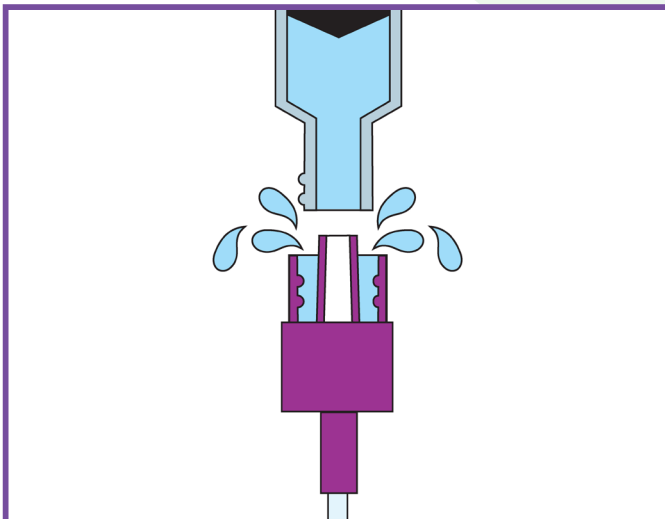

Following feeds or the delivery of medicines, it is good routine practice to flush the inside threads of the connector. This will prevent any disconnection problems.

Medicina ENFit Cleaning Procedure



Tube Cleaning Supplies & Terms



Cup of sterile or clean tap water

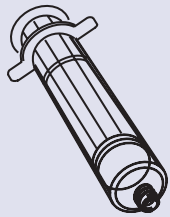

Syringe



Gauze

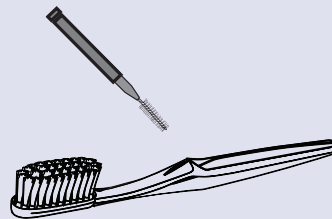

Cleaning tool/brush

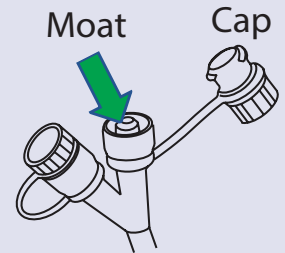

ENFit feeding tube

Note: Use a disposable brush (no ENFit specific tool or brush required).

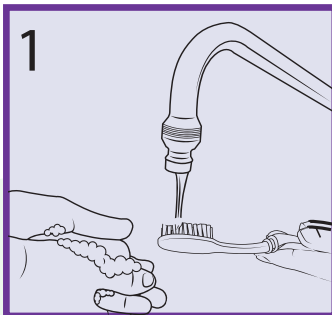

1 Wash hands with soap or use gloves. Rinse brush with tap water.

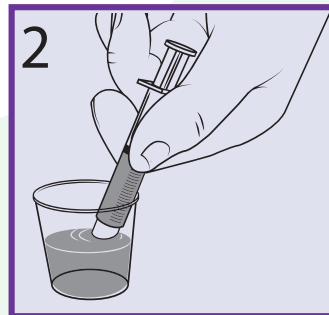

2 Fill syringe with water.

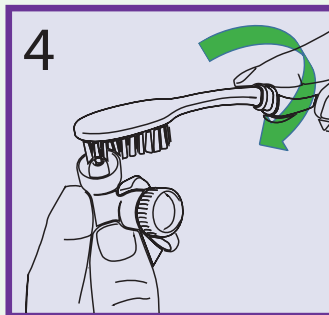

4 Rotate brush in the bottom of the moat.

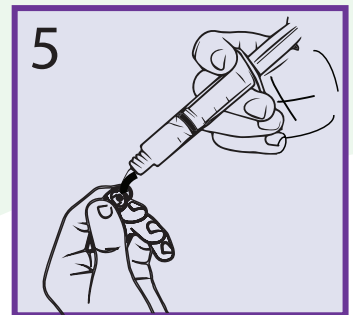

5 Rinse cap with clean tap water.

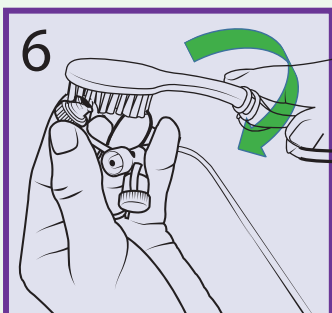

6 Insert bristles into feeding tube cap and rotate brush in cap to clean. Repeat steps 3-6 until cap and tube are clean.

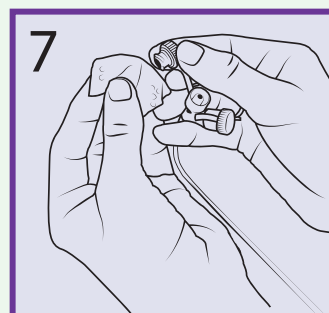

7 Wipe feeding tube port and cap with gauze. Clean supplies and allow to air dry.

Keeping ENFit connections clean:

Keeping the ENFit connections as clean as possible ensures minimal/no connection issues in the future.

Follow these instructions for feeding tubes with Male ENFit connectors (e.g. Nasogastric, Transpyloric, Orogastric, Percutaneous Endoscopic Gastrostomy Tubes and other ENFit devices).

Tips for keeping ENFit feeding tube ports clean:

- Inspect before you connect!
- Priming feeding sets - stop priming before fluid reaches the end of the tube
- ENFit syringe draw up - wipe medication and nutrition from the tip/outer threads and keep fluids out of the dead space before connecting to the feeding tube
- For the best results, follow these instructions and clean tubes at least once a day or whenever material is visible

For more information on the Medicina range, please contact us on **(02) 9882 3666**
or at **amsl@amsl.com.au**

amsl.com.au

PR-100-347 January 2020

